



KNX PBI-02

Push button interface 2-fold

Product description

The push button interface PBI-02 is a binary input device for insertion into flush-mounted switch boxes. Potential-free contacts can be connected to the inputs. The required voltage is supplied by the push button interface (no additional power supply is required).

The cables between switches/ push buttons and the push button interface must not exceed 10 m. The cable pairs must be twisted. The connected switches/ push-buttons can send commands to actuators for defined switching on/ off, for dimming lights, for moving blinds up/ down or for turning slats.

Security advices

- Electrical connection and start up operations shall only be done by electrically skilled persons.
- For installation, assemblage, operating and accident prevention please comply with the regional regulations.
- Connection and maintenance operation might only be done in de-energized condition.
- If safe operation is not possible, the device must not be started up or has to be disabled.
- The device shall only be applied for normal use and according to the specified technical data.
- The device may only be used in combination with original accessories.

Installation advices

- The device is intended for fixed installations in dry rooms, for installation in flush-mounted boxes.

Operating elements

- Programming button (A3) to switch between standard/ programming mode.

Display elements

- Programming-LED (A2) red for displaying standard/ programming mode.

Configuration

- Configuration by ETS version 3.0f or higher of the KNX Association.
- For detailed settings and functions, see separate application program description.

Start-up

- Check device, clamps and connections.
- Switch on the bus voltage, push the programming button and program the physical address.
- After programming the LED has to go out.



Technical Data



Connection data	Supply voltage	via KNX-bus (<10mA)
	Scanning voltage (contact open)	29VDC (bus voltage)
	Input current	0,2 mA per closed contact
	Input signal duration	min. 50ms
	Cable length	max. 10m (twisted pair, unshielded)
environment	Climate resistance	EN 50090-2-2
	Operating temperature	-5 °C to +45 °C
	Storage temperature	-25 °C to +60 °C
	Rel. humidity (non condensing)	5 % to 93 %
General	Dimensions (L x W x H)	42mm x 42mm x 11mm
	weight	approx. 22 g



Position and function of the display and control elements

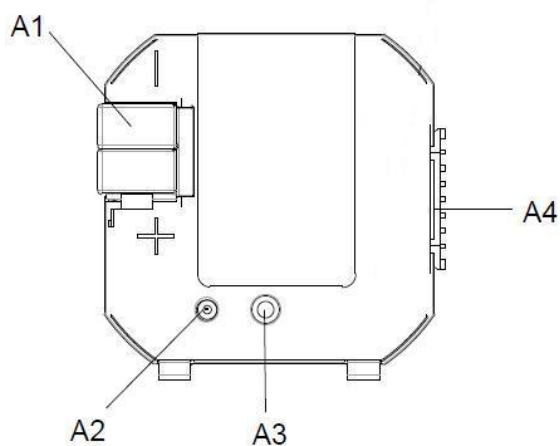

- A1 bus terminal for single with 0,6 – 0,8 mm Ø
- A2 Programming-LED red for displaying standard (LED off) or programming mode (LED on); the LED turns off automatically when the physical address has been programmed
- A3 Programming button to switch between standard/programming mode and to program the physical address.
- A4 Plug for cable set

Connection example

